

CONCURSOS

COMPETITIONS

CASE STUDY

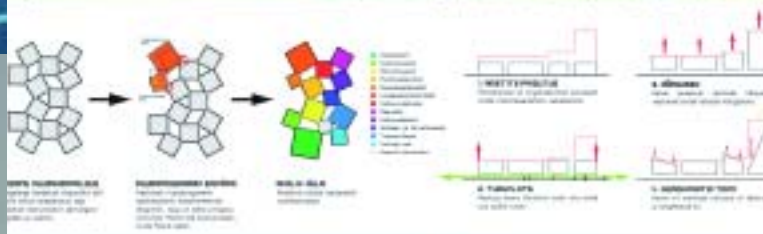
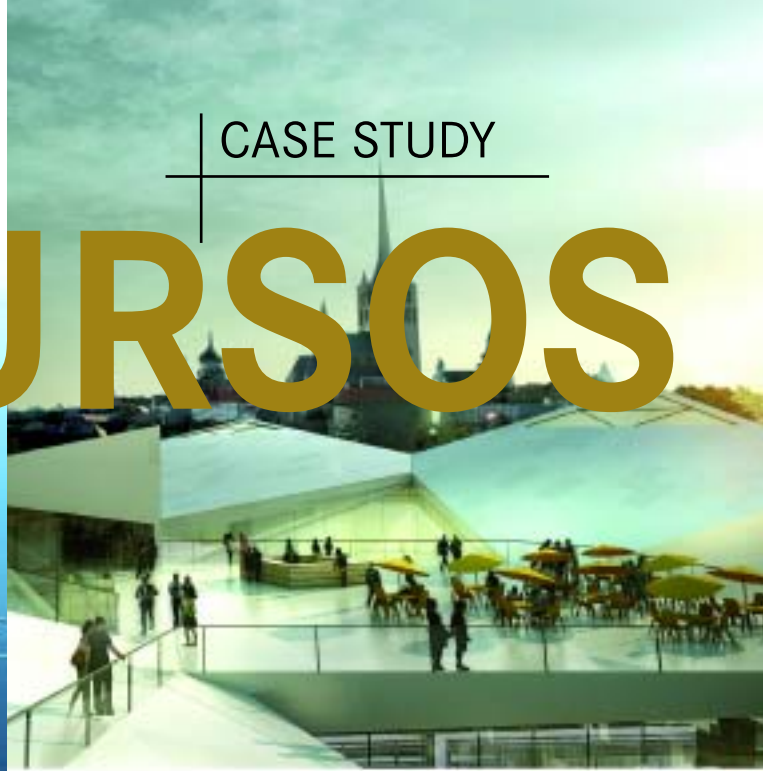

monsa



EDIFICIO INSTITUCIONAL CORREOS CHILE

Architect ZERAFA Architecture Studio (New York)
 AATA Arquitectos Asociados (Santiago)
 Year 2007
 Location Santiago de Chile, Chile
 Surface area 900 m²

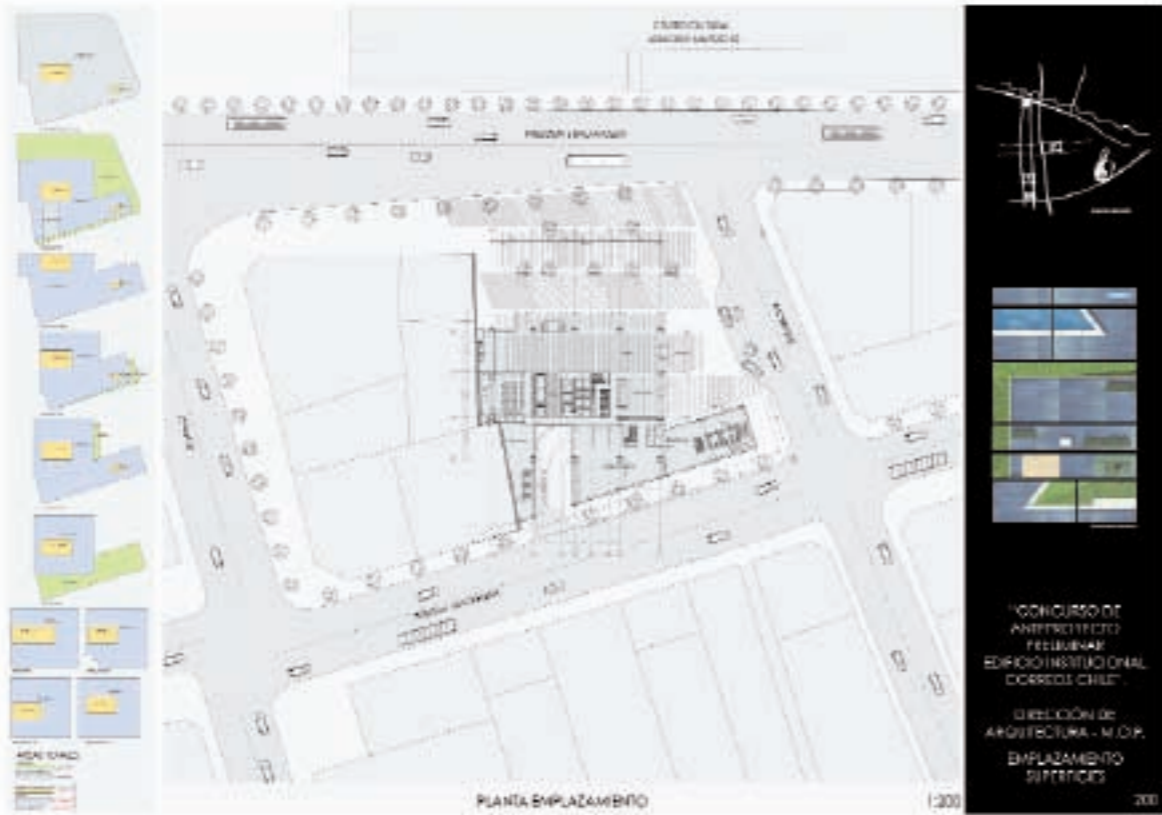
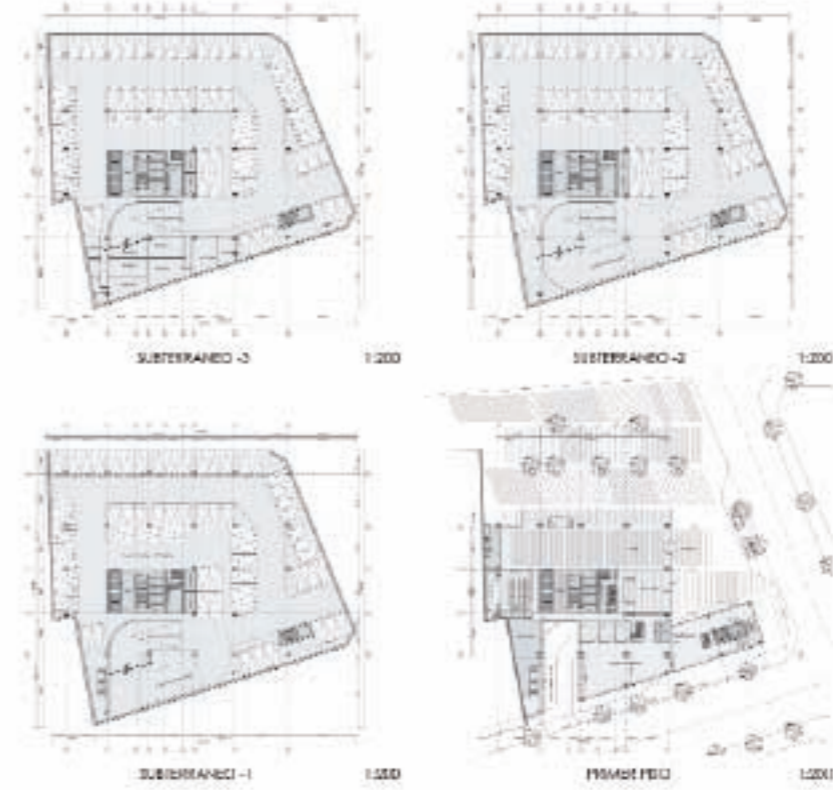
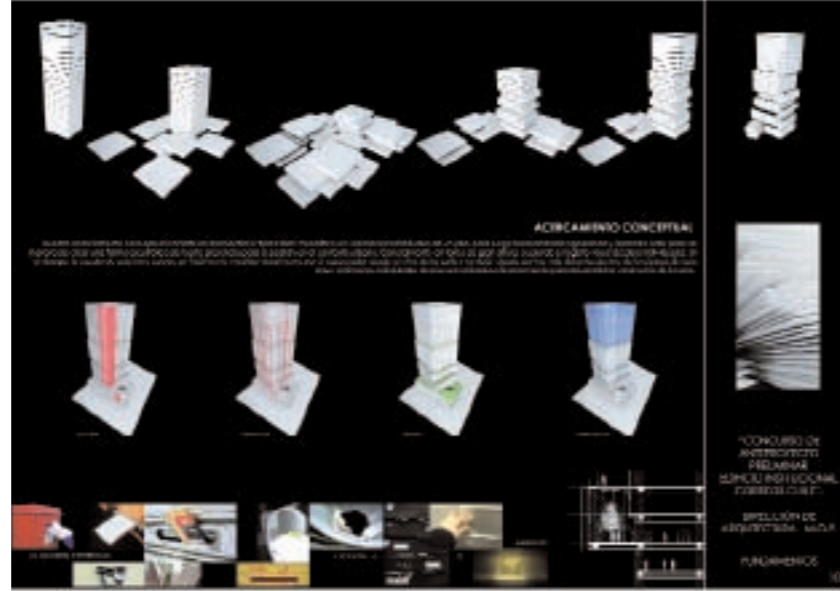

CHEOGNA CITY TOWER

Architect ZERAFÁ Architecture Studio (New York)
 AATA Arquitectos Asociados (Santiago)
 Year 2008
 Location Cheogna, South Korea
 Height 450 m

